

Additional Specialty Items Available From:



MUSHROOM FLANGE™ with Grate

SPECIFICATION SHEET

PROJECT	
DWG #	
ITEM #	

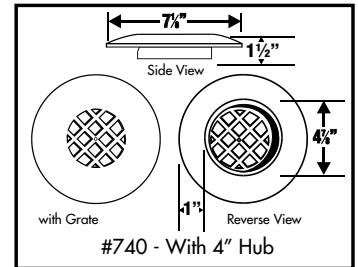
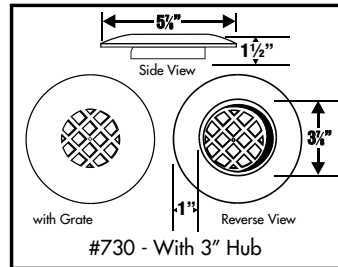
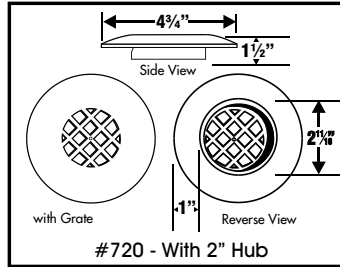
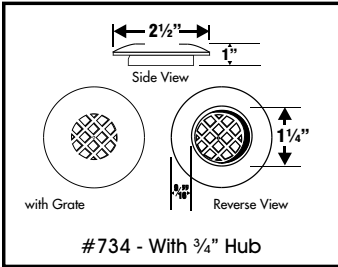

SUGGESTED SPECIFICATION

For a finished recessed look, rodent proofing and blockage free piping. Furnish and install Mushroom Flange # _____ manufactured by Plumberex Specialty Products, Inc.

COMMENTS:

PART #	COLOR	DIMENSIONS
734	White (A.B.S.)	3/4" (Hub)
720	White (A.B.S.)	2" (Hub)
730	White (A.B.S.)	3" (Hub)
740	White (A.B.S.)	4" (Hub)



FLOOR SINK CARRIER™

SPECIFICATION SHEET

PROJECT	
DWG #	
ITEM #	

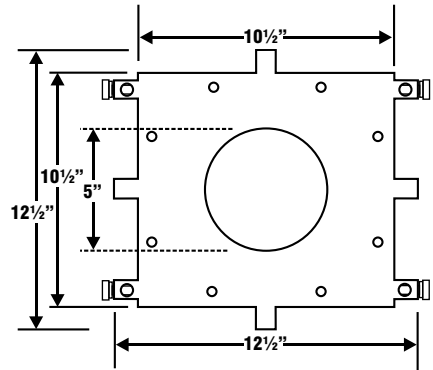
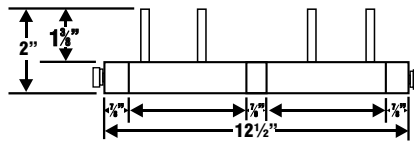
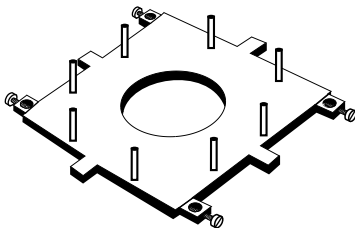

FLOOR SINK INSTALLATION SPECIFICATION

All floor sinks to be installed before concrete flooring is poured, to guarantee a one time, solid monolithic pour around every sink. No patchwork is to be allowed after flooring has been poured. All floor sink fixtures, traps and joints are to be pressure tested for leaks before concealing, as per all plumbing codes. No metal to metal contact shall be accepted as support of floor sink installation. For professional monolithic floors and secure, non metal to metal contact floor fixture installations, install Model #700 Floor Sink Carrier™ manufactured by Plumberex Specialty Products, Inc.

COMMENTS:

PART #	COLOR	DIMENSIONS
700	ABS Plastic	Floor Sink Carrier will fit 2", 3" & 4" Sink Connections



P.O. Box 1684 • Palm Springs, CA 92263 • (760) 343-7363 • 1-800-475-8629 • FAX 1-760-343-7366
Plumberex Specialty Products, Inc. reserves the right to make product changes or improvements at any time without notice.